



Data-Sheet-Fixed Capacitor

CKT50/9/27



www.glvac.cn

Specification	
Capacity C_{max} (nominal)	50pF
Voltage (Peak Test U_{pt} /Peak Working U_{pw})	15kV/9kV
Capacity tolerance	10%
Max. Current I_{max} at 13.56MHz with	27Arms
Conduction Cooling	20W
Net Weight	0.35kg

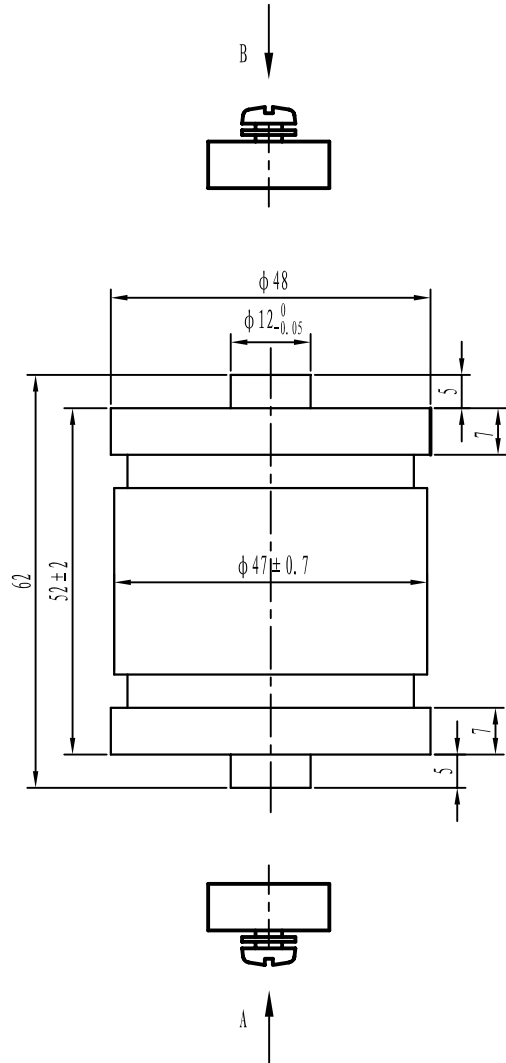

I_{max} at 25 °C ambient and 125 °C surface for convection and conduction (20w) cooling

